

1 EXISTING CONDITIONS PLAN

1" = 30'



CLIENT:
MANGANARO NORTHEAST, LLC

52 CUMMINGS PARK DRIVE
WOBURN, MA 01801

PRELIMINARY
NOT FOR CONSTRUCTION

MBG MAINE
EXPANSION AND RENOVATION

353 RIVERSIDE DRIVE
AUBURN, MAINE

ISSUED	NUMBER	DESCRIPTION	BY	DATE
	A	ISSUED FOR SITE PLAN REVIEW	ED	11/13/2023

SHEET TITLE:

EXISTING
CONDITIONS AND
DEMOLITION PLAN

DESIGNED BY: ED
DRAWN BY: BVD
PROJECT NUMBER: 23-079

C100

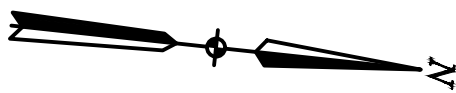

1 SITE AND LAYOUT PLAN

1" = 30'

GENERAL NOTES

- LOCATIONS OF UTILITIES ARE APPROXIMATE
- IT SHALL BE THE CONTRACTOR'S RESPONSIBILITY TO HAVE EACH UTILITY COMPANY LOCATE THEIR INDIVIDUAL SERVICES PRIOR TO THE START OF CONSTRUCTION.
- PRIOR TO THE BEGINNING OF CONSTRUCTION, THE CONTRACTOR SHALL SECURE A STREET OPENING PERMIT FROM THE AUBURN PUBLIC WORKS DEPARTMENT. NO FEE WILL BE CHARGED FOR THIS PERMIT.
- ALL THE UTILITY WORK SHALL BE DONE BY OTHERS.
- PROPERTY MARKERS AND STREET LINE MONUMENTS SHALL BE PROPERLY PROTECTED AND SHALL NOT BE DISTURBED. IF DISTURBED, THEY SHALL BE REPLACED BY A LICENSED SURVEYOR AT THE CONTRACTOR'S EXPENSE.
- ALL EXISTING CATCH BASINS, MANHOLES, CONNECTIONS, AND OUTLET PIPING SHALL BE CLEANED AND LEFT IN SATISFACTORY OPERATING CONDITION AFTER CONSTRUCTION HAS BEEN COMPLETED. NO SEPARATE PAYMENT WILL BE MADE FOR THIS WORK.
- ALL LAWN AREAS, WALKWAYS, AND DRIVEWAYS OUTSIDE THE WORK AREA, DAMAGED BY THE CONTRACTOR, SHALL BE REPAIRED BY THE CONTRACTOR AT NO EXPENSE TO THE CITY.
- THE CONTRACTOR SHALL BE RESPONSIBLE FOR THE PRESERVATION OF ALL TREES AND SHRUBS ON THE PROJECT WHICH ARE NOT REMOVED.
- EXISTING PAVEMENT SHALL BE SAW CUT AND BUTTED TO THE NEW PAVEMENT. NO FEATHERING OF PAVEMENT WILL BE PERMITTED.
- EXISTING DRAINAGE STRUCTURES SHALL NOT BE DISTURBED UNLESS OTHERWISE NOTED.
- ALL EXISTING DRAINAGE PIPES TO BE ABANDONED SHALL BE PLUGGED WITH CONCRETE OR AS DIRECTED BY THE PROJECT ENGINEER.

- BEFORE CONNECTION NEW PIPES TO AN EXISTING SEWER LINE, THE CONTRACTOR SHALL NOTIFY THE SEWER MAINTENANCE DIVISION OF THE AUBURN PUBLIC WORKS DEPARTMENT. NO WORK SHALL BE DONE WITHOUT THEIR APPROVAL.
- NO ADDITIONAL PAYMENT WILL BE MADE FOR GRADING SIDE SLOPES OF DRIVEWAYS.
- THE CONTRACTOR SHALL BE RESPONSIBLE FOR REPAIRING ANY TRENCH PAVEMENT THAT HAS EXPERIENCED EXCESSIVE SETTLEMENT, CRACKING, OR OPENING OF JOINTS, REPAIRS MAY INCLUDE OVERLAY, REMOVAL OF UNACCEPTABLE MATERIALS, COMPLETE REPLACEMENT, JOINT SEALING, OR REBUTTING PAVEMENT AS REQUIRED. THIS WORK MAY BE NECESSARY AFTER THE FINAL ACCEPTANCE OF WORK OR PRIOR TO THE END OF THE ONE YEAR GUARANTEE. THIS WORK SHALL BE DONE AT THE CONTRACTOR'S EXPENSE.
- ALL MANHOLE FRAMES SHALL BE SUPPLIED WITH SOLID MANHOLE COVERS. SEE STANDARD DETAIL.
- NEW CATCH BASINS SHALL BE INSTALLED WITH A TYPE A-4 CATCH BASIN INLET STONE.
- NO ADDITIONAL PAYMENT WILL BE MADE FOR THE REMOVAL OF EXISTING PIPES.
- ALL GRANITE CATCH BASIN STONES, MANHOLE FRAMES AND COVERS TO BE REMOVED SHALL BE DELIVERED TO THE CITY STOCK YARD AS DIRECTED. NO SEPARATE PAYMENT WILL BE MADE FOR THIS WORK. THESE EXISTING MATERIALS MAY BE REUSED AS DIRECTED BY THE PROJECT ENGINEER.
- ALL TERMINAL MANHOLES SHALL HAVE CHANNELS CONSTRUCTED STRAIGHT THROUGH THE MANHOLE.
- THE CONTRACTOR SHALL BE RESPONSIBLE FOR LOCATION AND RECONNECTING EXISTING SEWER LATERALS TO NEW SEWER. PAYMENT WILL BE UNDER THE RESPECTIVE UNIT BID ITEM AS SPECIFIED IN THE CONTRACT DOCUMENT.

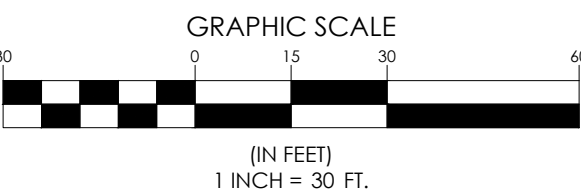

CITY OF AUBURN PLANNING BOARD APPROVAL:

CHAIR: _____ DATE: _____

EXISTING	DESCRIPTION	PROPOSED
	GRANITE MONUMENT - 3' OFFSET	
	IRON PIN FOUND/SET	
	IRON ROD FOUND	
	CAPPED IRON ROD FOUND	
	DRILL HOLE FOUND	
	GRANITE MONUMENT FOUND	
	STREET LINE	
	LOT SETBACKS	
	PROPERTY LINE	
	ABUTTER LINE	
	"NO CUT" BUFFER	
	WETLANDS	
	EDGE OF ROAD/TRAVELED WAY	
	SOIL TEST PIT	
	CONTOUR	
	SPOT GRADE	
	GAS SHUT-OFF	
	UTILITY POLE	
	OVERHEAD UTILITIES	
	UNDERGROUND ELECTRICAL	
	ELECTRICAL TRANSFORMER	
	FIRE HYDRANT	
	WATER LINE	
	WATER GATE	
	SEWER LINE	
	SEWER MANHOLE	
	DRAINAGE MANHOLE	
	CATCH BASIN	
	STORMDRAIN	
	UNDERDRAIN	
	SILT FENCE	
	TEMP. STONE CHECK DAM	
	GRADING AND FLOW DIRECTION	
	HAY BALES	
	EROSION CONTROL BLANKET	
	STORMWATER BOUNDARY	
	STORMWATER FLOW (TO)	
	FACE OF LEDGE OUTCROP	
	BIRCH	
	MAPLE	
	TREE LINE	
	SITE LIGHTING (BAYSIDE FIXTURE)	
	STONE WALL	

SHEET TITLE:

SITE AND LAYOUT PLAN

DESIGNED BY: _____ ED
DRAWN BY: _____ BVD
PROJECT NUMBER: 23-079

C101



CLIENT:
MANGANARO NORTHEAST, LLC

52 CUMMINGS PARK DRIVE
WOBURN, MA 01801

PRELIMINARY
NOT FOR CONSTRUCTION

MBG MAINE EXPANSION AND RENOVATION

353 RIVERSIDE DRIVE
AUBURN, MAINE

ISSUED	DESCRIPTION	BY	DATE
A	ISSUED FOR SITE PLAN REVIEW	ED	11/13/2023

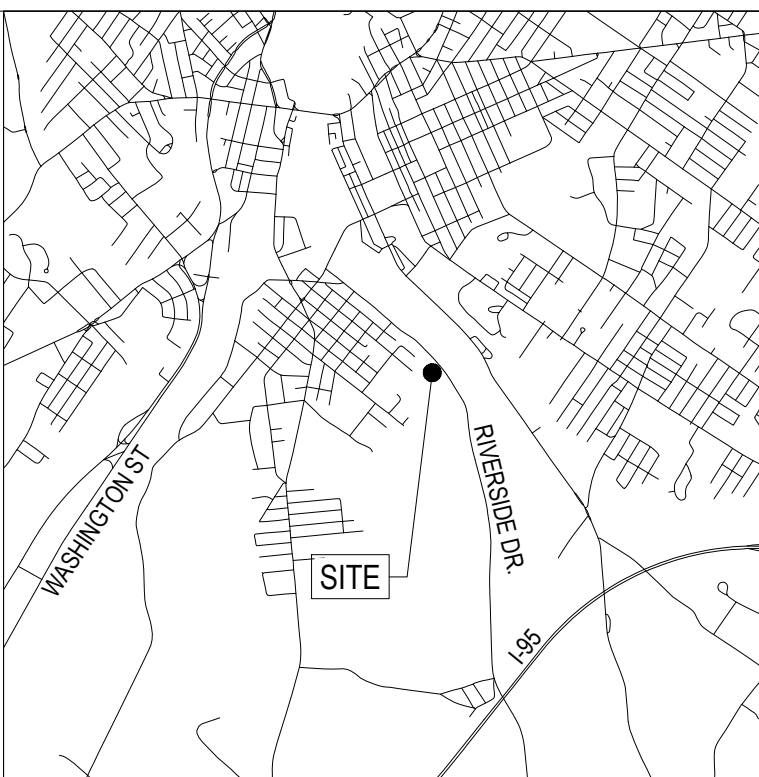

LOCATION MAP

N.T.S.

PARKING:
TOTAL EXISTING SPACES = 15
TOTAL PROPOSED STANDARD SPACES = 18
TOTAL PROPOSED ACCESSIBLE SPACES = 2
TOTAL PROPOSED SPACES = 20

IMPERVIOUS AREA TABLE

TYPE OF COVER	EXISTING IMP. AREA (S.F.)	PROPOSED IMP. AREA (S.F.)
BUILDING	24,900 S.F.	41,850 S.F.
PAVEMENT	43,700 S.F.	34,250 S.F.
TOTAL	68,600 S.F.	76,000 S.F.
CHANGE FROM EXISTING (+/-)	-	7,400 S.F.
PERCENT CHANGE (+/-)	-	10.8%
IMPERVIOUS SURFACE RATIO	70.3%	77.9%

ZONING SUMMARY (INDUSTRIAL, LOT 202-005)

	EXISTING	PROPOSED
MIN. LOT AREA		
STREET FRONTAGE	150'	496'±
MIN. FRONT YARD	35'	45'
MIN. REAR YARD	40'	54'±
MIN. SIDE YARD	35'	35'±
MAX. BUILDING HEIGHT	75'	<75'
USE DESIGNATION	LIGHT INDUSTRIAL	LIGHT INDUSTRIAL

LEGEND

EXISTING	DESCRIPTION	PROPOSED
	GRANITE MONUMENT - 3' OFFSET	
	IRON PIN FOUND/SET	
	IRON ROD FOUND	
	CAPPED IRON ROD FOUND	
	DRILL HOLE FOUND	
	GRANITE MONUMENT FOUND	
	STREET LINE	
	LOT SETBACKS	
	PROPERTY LINE	
	ABUTTER LINE	
	"NO CUT" BUFFER	
	WETLANDS	
	EDGE OF ROAD/TRAVELED WAY	
	SOIL TEST PIT	
	CONTOUR	
	SPOT GRADE	
	GAS SHUT-OFF	
	UTILITY POLE	
	OVERHEAD UTILITIES	
	UNDERGROUND ELECTRICAL	
	ELECTRICAL TRANSFORMER	
	FIRE HYDRANT	
	WATER LINE	
	WATER GATE	
	SEWER LINE	
	SEWER MANHOLE	
	DRAINAGE MANHOLE	
	CATCH BASIN	
	STORMDRAIN	
	UNDERDRAIN	
	SILT FENCE	
	TEMP. STONE CHECK DAM	
	GRADING AND FLOW DIRECTION	
	HAY BALES	
	EROSION CONTROL BLANKET	
	STORMWATER BOUNDARY	
	STORMWATER FLOW (TO)	
	FACE OF LEDGE OUTCROP	
	BIRCH	
	MAPLE	
	TREE LINE	
	SITE LIGHTING (BAYSIDE FIXTURE)	
	STONE WALL	

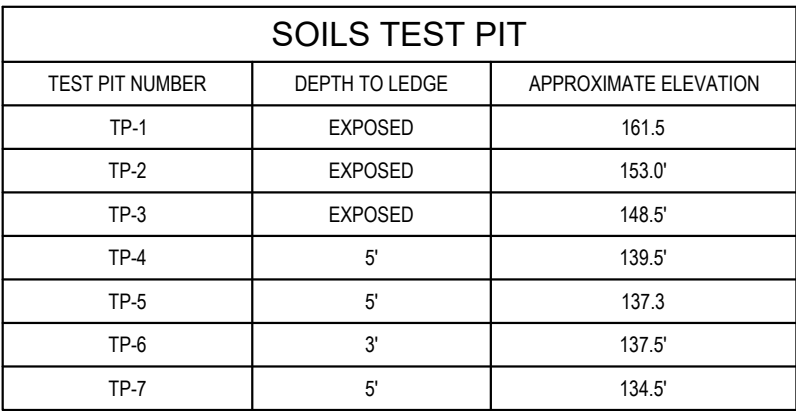

TRILLIUM
ENGINEERING GROUP
189 MAIN STREET SUITE 200
YARMOUTH, ME 04096

CLIENT:
MANGANARO NORTHEAST, LLC

52 CUMMINGS PARK DRIVE
WOBURN, MA 01801

PRELIMINARY
NOT FOR CONSTRUCTION

MBG MAINE
EXPANSION AND RENOVATION

353 RIVERSIDE DRIVE
AUBURN, MAINE

[illegible]

SHEET TITLE

GRADING AND DRAINAGE PLAN

DESIGNED BY: _____ ED _____

DRAWN BY: BVD

PROJECT NUMBER: 23-079

C102

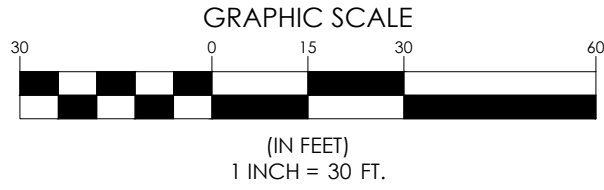

1 GRADING AND DRAINAGE PLAN
1" = 30'

$$1'' = 30$$

Z:\01 - PROJECTS\2023\23-079 OST RENOVATION\03 - DWG\23-079-C100.DWG - 11/13/2023 - BRAD VAN DAMM

MBG MAINE
EXPANSION AND RENOVATION

353 RIVERSIDE DRIVE
AUBURN, MAINE

ISSUED				
NUMBER	DESCRIPTION	BY	DATE	
A	ISSUED FOR SITE PLAN REVIEW	ED	11/13/2023	

SHEET TITLE:

VEHICLE
MOVEMENT PLANS

DESIGNED BY: ED
DRAWN BY: BVD
PROJECT NUMBER: 23-079

C103

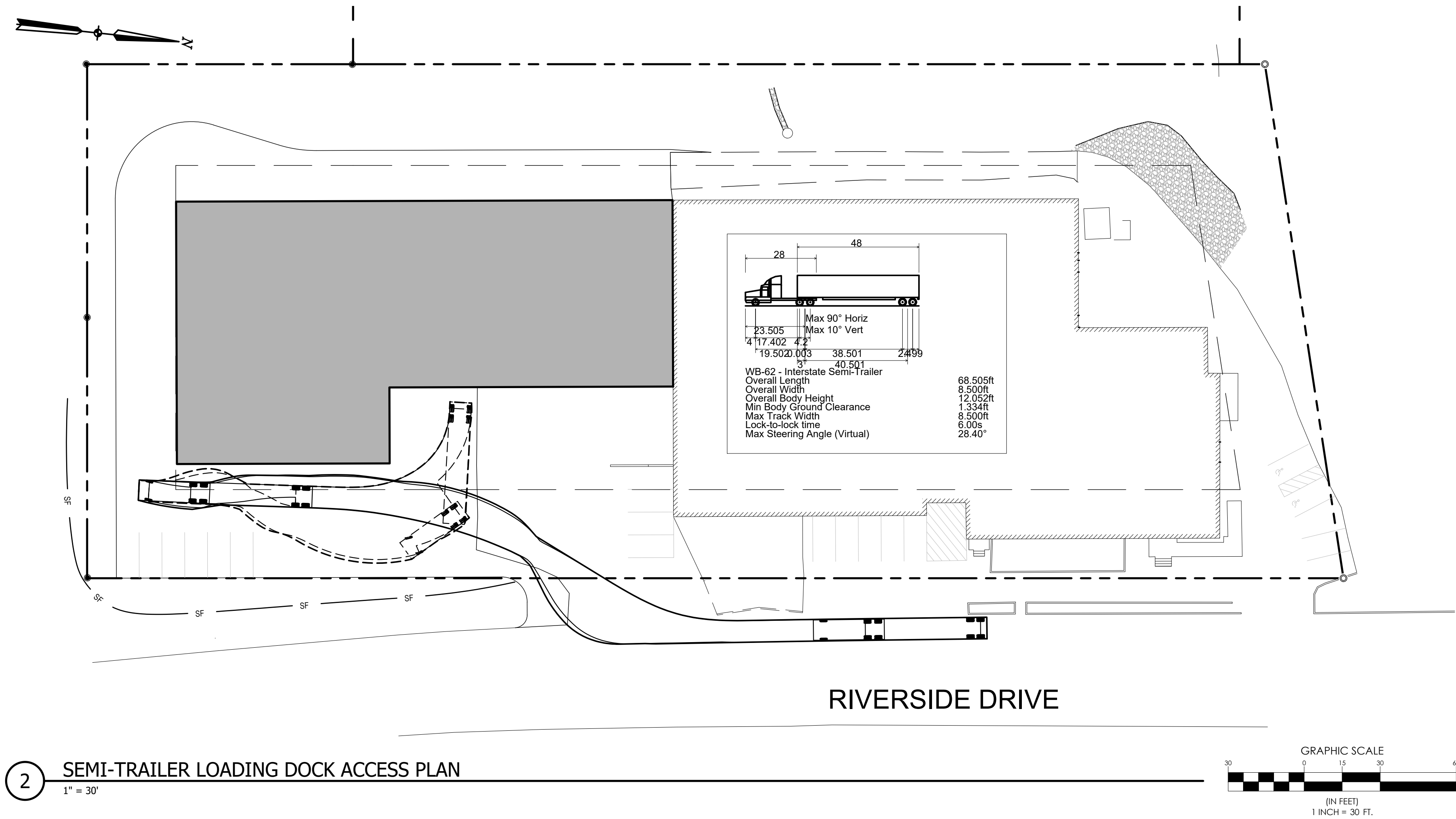
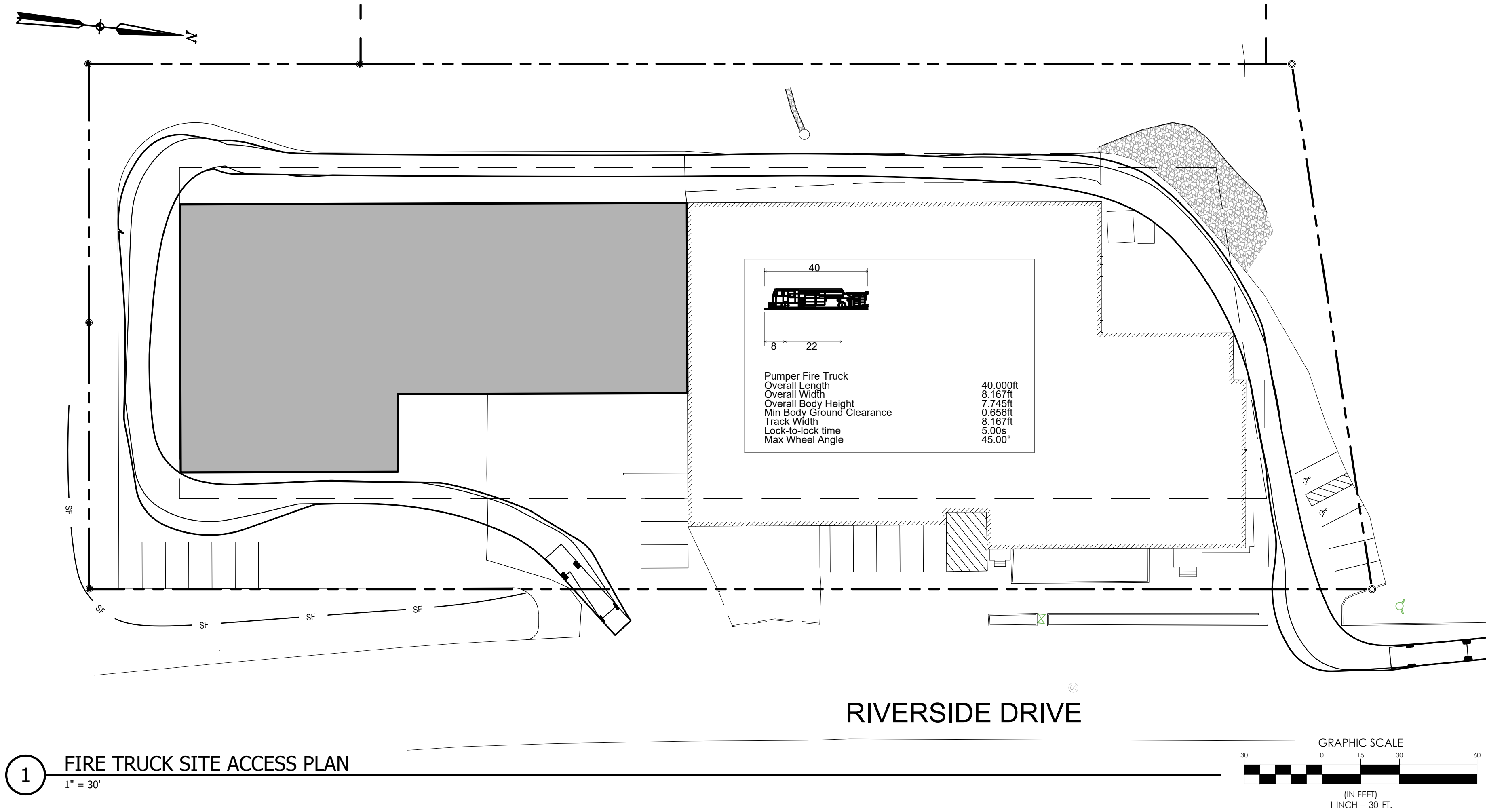

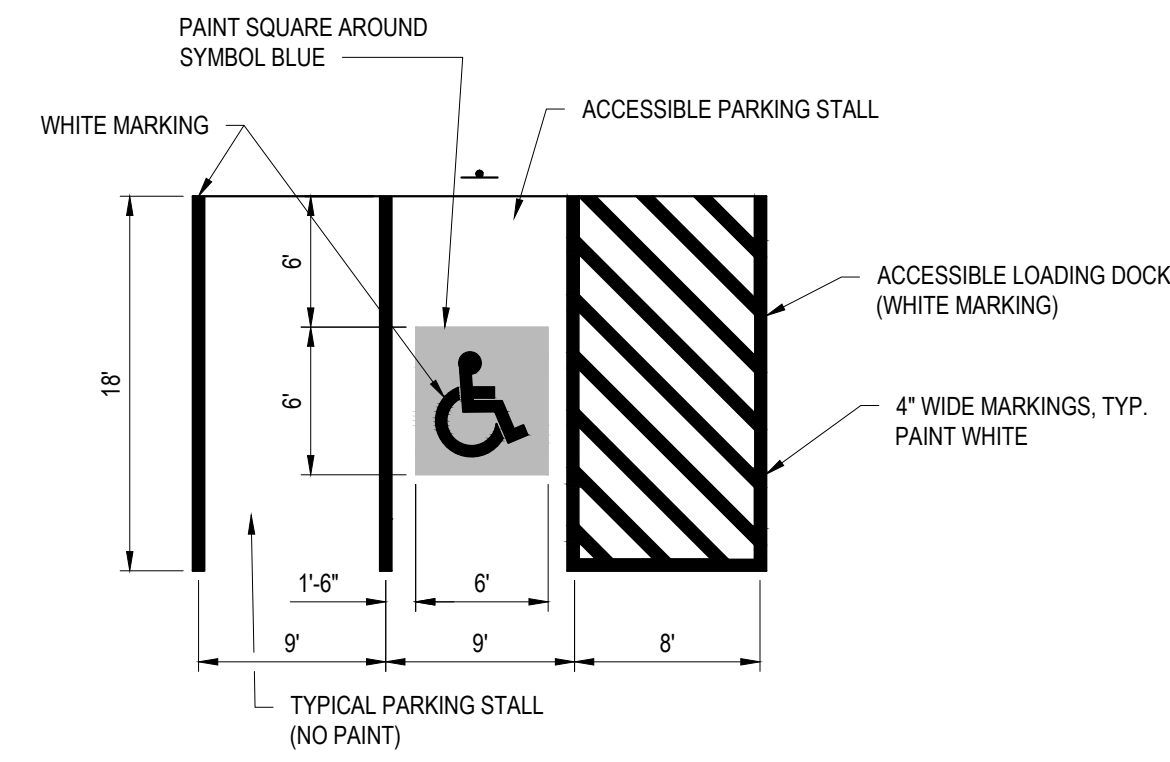
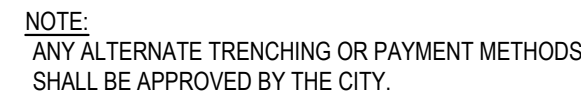
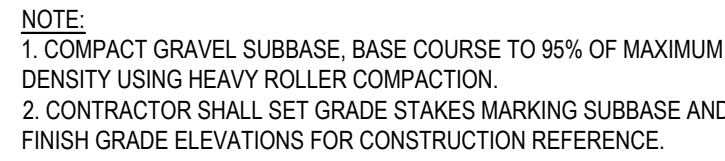

NTS



NTS

NTS



REFERENCE "STANDARD SPECIFICATIONS FOR CONSTRUCTION OF ROADS AND BRIDGES ON FEDERAL HIGHWAY PROJECTS", FP-96, SECTION 718.01 AND "MANUAL ON UNIFORM TRAFFIC CONTROL DEVICES" 2009 EDITION

NTS



NOTES:

1. CONSULT WITH IF&W IF FISH PASSAGE WILL BE INHIBITED DURING LOW FLOWS.
2. REFER TO DESIGN NOTES AND LIMITATIONS IN TEXT ON PIPE OUTLET PROTECTION.
3. IN DEFINED CHANNELS, APRON SHALL EXTEND FULL WIDTH OF BOTTOM AND ONE FOOT ABOVE MAX. TAILWATER OR UP TO BANK FULL, WHICHEVER IS LESS.

CULVERT OUTLET DETAIL

NOT TO SCALE

[illegible]

SHEET TITLE:

SITE DETAILS

C200

1. THIS PLAN HAS BEEN DEVELOPED TO PROVIDE A STRATEGY FOR DEALING WITH SOIL EROSION AND SEDIMENTATION DURING AND AFTER PROJECT CONSTRUCTION. THIS PLAN IS BASED ON THE STANDARD AND SPECIFICATIONS FOR EROSION PREVENTION AS CONTAINED IN THE MAINE EROSION AND SEDIMENT CONTROL HANDBOOK FOR CONSTRUCTION: "MAINE EROSION AND SEDIMENT CONTROL BMPs" PUBLISHED BY THE MAINE DEP, LATEST EDITION.

1. EROSION/SEDIMENT CONTROL DEVICES

- ### CONSTRUCTION PHASE

THE FOLLOWING GENERAL PRACTICES WILL BE USED TO PREVENT EROSION DURING CONSTRUCTION OF THIS PROJECT.

- ### POST-CONSTRUCTION REVEGETATION

THE FOLLOWING GENERAL PRACTICES WILL BE USED TO PREVENT EROSION AS SOON AS AN AREA IS READY TO UNDERGO FINAL GRADING.

- ### MONITORING SCHEDULE

THE CONTRACTOR IS RESPONSIBLE FOR INSTALLING, MONITORING, MAINTAINING, REPAIRING, REPLACING AND REMOVING ALL OF THE EROSION AND SEDIMENTATION CONTROLS OR APPOINTING A QUALIFIED SUBCONTRACTOR TO DO SO. MAINTENANCE MEASURES WILL BE APPLIED AS NEEDED DURING THE ENTIRE CONSTRUCTION CYCLE. AFTER EACH RAINFALL, A VISUAL INSPECTION WILL BE MADE OF ALL EROSION AND SEDIMENTATION CONTROLS AS FOLLOWS:

-
- The technical drawing illustrates the construction of a catch basin. It includes three views:
 - Top View:** Shows a circular grate with a grid pattern. A label "GRATE" points to it.
 - Side View:** Shows the basin's profile. It features a "DUMP STRAP" on the side, a "1\" REBAR FOR BAG REMOVAL FROM CATCH BASIN" at the top edge, and a "SILTSACK" at the bottom. A dimension line indicates the "DEPTH=1.5'".
 - Front View:** Shows a cylindrical structure with a diameter of 4 feet and a depth of 1.5 feet. It contains a siltsack and a dump strap. Labels "DIAMETER = 4 FEET" and "DEPTH = 1.5 FEET" are provided.

1. REMOVE THE CATCH BASIN GRATE AND PLACE THE SACK INTO THE OPENING. HOLD OUT APPROXIMATELY SIX (6) INCHES OF THE SACK BEYOND THE BASIN FRAME TO ALLOW ACCESS TO THE "SILT/SACK" LIFTING STRAPS. REPLACING THE GRATE BACK INSIDE OF THE FRAME WILL HOLD THE SACK IN PLACE.
2. THE CONTRACTOR SHALL BE RESPONSIBLE FOR MONITORING AND MAINTAINING THIS SEDIMENT CONTROL DEVICE. THE SACK IS CONSIDERED FULL AND READY TO EMPTY WHEN THE TIE "RESTRAINT CORD" IS NO LONGER VISIBLE.
3. THE "SILT/SACK" IS REMOVED BY PLACING TWO (2) PIECES IF 1 INCH DIAMETER REBAR THROUGH THE LIFTING LOOPS LOCATED ON EACH SIDE OF THE SACK AND LIFTING WITH AN APPROPRIATE PIECE OF CONSTRUCTION EQUIPMENT. THE LIFTING STRAPS ARE CONNECTED TO THE BOTTOM OF THE SACK AND THE LIFTING ACTION WILL CAUSE THE SACK TO INVERT OUTSIDE OUT, AND EMPTYING THE CONTENTS. THE SACK SHOULD THEN BE CLEANED, RINSED AND RETURNED TO ITS ORIGINAL SHAPE AND PLACED BACK IN THE BASIN.
4. THE "SILT/SACK" IS SEDIMENTABLE. THEREFORE, ONCE THE CONSTRUCTION CYCLE IS COMPLETE, REMOVE THE SACK FROM THE BASIN, CLEAN AND STORE OUT OF DIRECT SUNLIGHT UNTIL ITS NEXT USE.
5. THE "SILT/SACK" SEDIMENT CONTROL DEVICE IS MANUFACTURED BY: ACF ENVIRONMENTAL.

1. WINTER CONSTRUCTION PERIOD: NOVEMBER 1 THROUGH APRIL 15.
2. WINTER EXCAVATION AND EARTHWORK SHALL BE COMPLETED SUCH THAT NO MORE THAN 1 ACRE OF THE SITE IS WITHOUT STABILIZATION AT ANY ONE TIME.
3. EXPOSED AREA SHALL BE LIMITED TO THOSE AREAS TO BE MULCHED IN ONE DAY PRIOR TO ANY SNOW EVENT. AT THE END OF EACH WORK WEEK NO AREAS MAY BE LEFT UNSTABILIZED OVER THE WEEKEND.
4. CONTINUATION OF EARTHWORK OPERATIONS ON ADDITIONAL AREAS SHALL NOT BEGIN UNTIL THE EXPOSED SOIL SURFACE ON THE AREA BEING WORKED HAS BEEN STABILIZED, SUCH THAT NO LARGER AREA OF THE SITE IS WITHOUT EROSION CONTROL PROTECTION AS LISTED IN ITEM 2 ABOVE.
5. AN AREA SHALL BE CONSIDERED TO HAVE BEEN STABILIZED WHEN EXPOSED SURFACES HAVE BEEN EITHER MULCHED WITH STRAW OR HAY AT A RATE OF 150 LB PER 1000 SF. (WITH OR WITHOUT SEEDING) OR DORMANT SEEDING, MULCHED AND ANCHORED SUCH THAT SOIL SURFACE IS NOT VISIBLE THROUGH THE MULCH. NOTE: AN AREA IS ALSO CONSIDERED STABLE IF SODDERED, COVERED WITH GRAVEL (PARKING LOTS) OR STABILIZED SAND.
6. BETWEEN THE DATES OF OCTOBER 15 AND APRIL 1, LOAM OR SEED WILL NOT BE REQUIRED. DURING PERIODS OF ABOVE FREEZING TEMPERATURES THE SLOPS SHALL BE FINE GRADED AND EITHER PROTECTED WITH MULCH OR TEMPORARILY SEEDING AND MULCHED UNTIL SUCH TIME AS THE FINAL TREATMENT CAN BE APPLIED. IF THE DATE IS AFTER NOVEMBER 1 AND IF THE EXPOSED AREA HAS BEEN LOAMED, FINAL GRADED WITH A UNIFORM SURFACE, THEN THE AREA MAY BE DORMANT SEED AT A RATE OF 3 TIMES HIGHER THAN SPECIFIED FOR PERMANENT SEED AND THEN MULCHED. IF CONSTRUCTION CONTINUES DURING FREEZING WEATHER, ALL EXPOSED AREAS SHALL BE CONTINUOUSLY GRADED BEFORE FREEZING AND THE SURFACE TREATED WITH FRESH OR CUMULATIVE MULCH. MULCH SHALL BE APPLIED BY THE MULCH SLOPS SHALL NOT BE LEFT UNEXPOSED OVER THE WINTER OR ANY OTHER EXTENDED TIME OF WORK SUSPENSION UNLESS TREATED IN THE ABOVE MANNER. UNTIL SUCH TIME AS WEATHER CONDITIONS ALLOW, DITCHES TO BE FINISHED WITH THE PERMANENT SURFACE TREATMENT, EROSION SHALL BE CONTROLLED BY THE INSTALLATION OF BALES OF HAY, SILT FENCE OR STONE CHECK DAMS IN ACCORDANCE WITH THE STANDARD DETAILS SHOWN ON THE DESIGN DRAWINGS. NOTE: DORMANT SEEDING SHOULD NOT BE ATTEMPTED UNLESS SOIL TEMPERATURE REMAINS BELOW 50 DEGREES AND DAY/TIME TEMPERATURES REMAIN IN THE 30'S.
7. MULCH NETTING SHALL BE USED TO ANCHOR MULCH IN ALL DRAINAGE WAYS WITH A SLOPE GREATER THAN 3% FOR SLOPES EXPOSED TO DIRECT WINDS AND FOR ALL OTHER SLOPES GREATER THAN 8%. VEGETATED DRAINAGE SLOPES SHALL BE UNED WITH A SLOPE OF 10% OR GREATER.
8. MULCH NETTING SHALL BE USED TO ANCHOR MULCH IN ALL DRAINAGE WAYS WITH SLOPES GREATER THAN 15%. AFTER OCTOBER 1 THE SAME APPLIES FOR ALL SLOPES GREATER THAN 8%.
9. BETWEEN THE DATES OF OCTOBER 15 TO NOVEMBER 1, WINTER RYE IS RECOMMENDED FOR STABILIZATION. AFTER NOVEMBER 1, WINTER RYE IS NOT EFFECTIVE. AROUND NOVEMBER 15 OR LATER, ONCE TEMPERATURES OF THE AIR AND SOIL PERMIT, DORMANT SEEDING IS EFFECTIVE.
10. IN THE EVENT OF SNOWFALL (FRESH OR CUMULATIVE) GREATER THAN 1 INCH DURING WINTER CONSTRUCTION PERIOD ALL SNOW SHALL BE REMOVED FROM THE AREAS OF SEEDING AND MULCHING PRIOR TO PLACEMENT.

1. WEEKLY INSPECTIONS, AS WELL AS ROUTINE INSPECTIONS FOLLOWING RAIN FALLS, SHALL BE CONDUCTED BY THE GENERAL CONTRACTOR OF ALL TEMPORARY AND PERMANENT EROSION CONTROL DEVICES UNTIL FINAL ACCEPTANCE OF THE PROJECT (85% GRASS CATCH). NECESSARY REPAIRS SHALL BE MADE TO CORRECT UNDERMINING OR DETERIORATION. FINAL ACCEPTANCE SHALL INCLUDE A SITE INSPECTION TO VERIFY THE STABILITY OF ALL DISTURBED AREAS AND SLOPES. UNTIL FINAL INSPECTION, ALL EROSION AND SEDIMENTATION CONTROL MEASURES SHALL IMMEDIATELY BE CLEANED, AND REPAIRED BY THE GENERAL CONTRACTOR AS REQUIRED. DISPOSAL OF ALL TEMPORARY EROSION AND CONTROL DEVICES SHALL BE THE RESPONSIBILITY OF THE GENERAL CONTRACTOR.

IT IS RECOMMENDED THAT THE OWNER HIRE THE SERVICES OF THE DESIGN ENGINEER TO PROVIDE COMPLIANCE INSPECTIONS (DURING ACTIVE CONSTRUCTION) RELATIVE TO IMPLEMENTATION OF THE STORMWATER AND EROSION CONTROL PLANS. SUCH INSPECTIONS SHOULD BE LIMITED TO ONCE A WEEK OR AS NECESSARY AND BE REPORTABLE TO THE OWNER, TOWN AND DEP.

2. SHORT-TERM SEDIMENTATION MAINTENANCE SHALL BE THE RESPONSIBILITY OF THE CONTRACTOR TO CLEAN OUT ALL SWALES AND STRUCTURES PRIOR TO TURNING PROJECT OVER TO THE CITY.

1. LONG-TERM PROVISIONS FOR PERMANENT MAINTENANCE OF ALL EROSION AND SEDIMENTATION CONTROL FACILITIES AFTER ACCEPTANCE OF THE PROJECT SHALL BE THE RESPONSIBILITY OF THE OWNER OR THEIR DESIGNEE. SUCH RESPONSIBILITIES INCLUDE BUT ARE NOT LIMITED TO THOSE DETAILED AS FOLLOWS:

3. A. PARKING LOT SHALL BE MECHANICALLY SWEEPED TWICE PER YEAR. THE FIRST SHALL TAKE PLACE IN THE MID WINTER (JANUARY THRU) TO REMOVE ACCUMULATED SANDS FROM WINTER SANDING TO THIS POINT. THE SECOND SWEEPING SHALL TAKE PLACE AFTER WINTER SANDING OPERATIONS TERMINATE BUT PRIOR TO MAY 1.
- B. INSPECTION OF STORMWATER OUTLET STRUCTURE SHOULD BE CONDUCTED TWICE PER YEAR. ACCESS TO THE STRUCTURE IS THROUGH THE TOP. THE OIL/WATER SEPARATOR UNIT SHALL BE PUMPED DOWN AND THE SEDIMENT AND TRASH SHALL BE REMOVED AT THE TIME OF THE INSPECTION. THE REMOVAL OF SEDIMENT AND TRASH WILL HELP MINIMIZE VOLUME LOSS.
2. THE OWNER SHALL FILE A YEARLY MAINTENANCE REPORT TO THE CITY DOCUMENTING THE REQUIRED MAINTENANCE FOR THE STORMWATER SYSTEM.

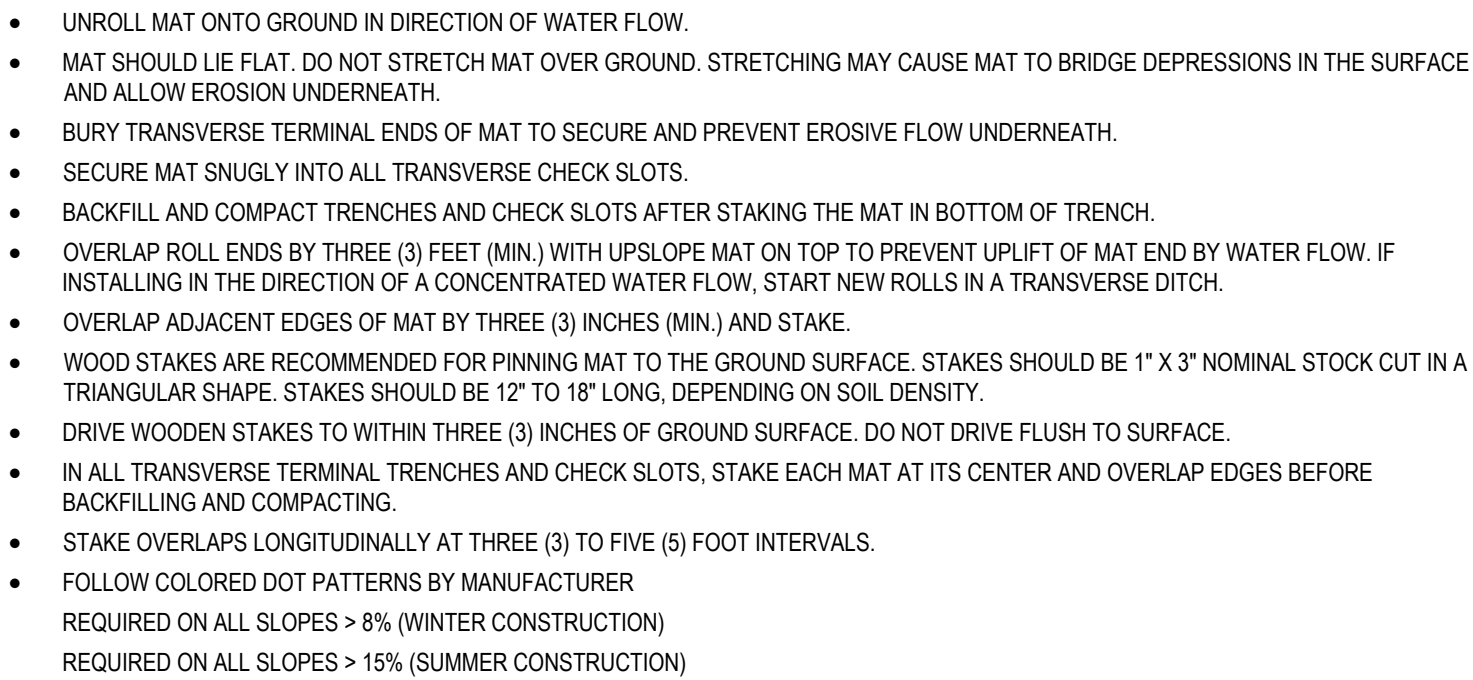

NTS

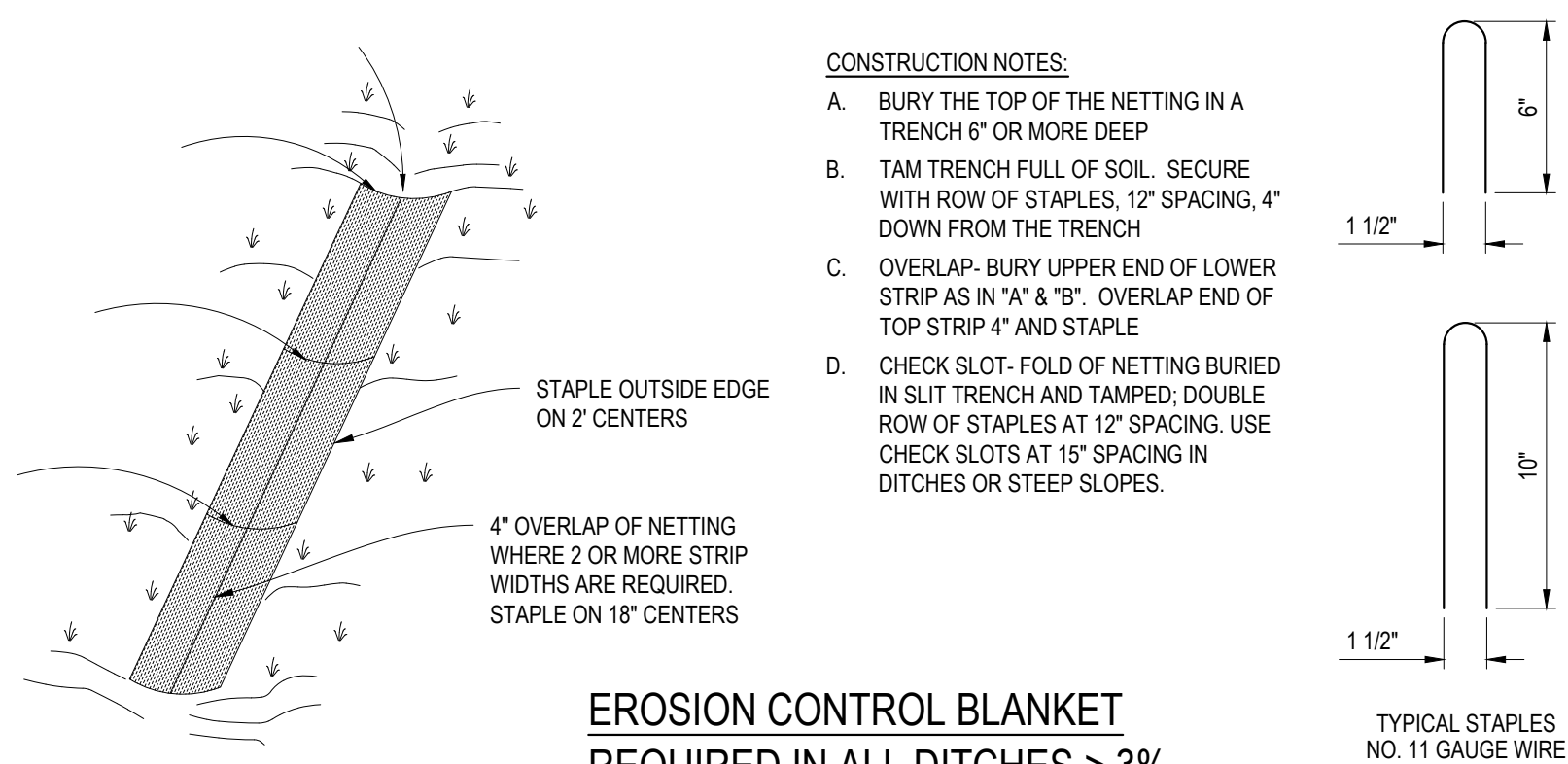

NOTE: GRADING PLAN GOVERNS IN ALL LOCATIONS

NOTE: GRADING PLAN GOVERNS IN ALL LOCATIONS

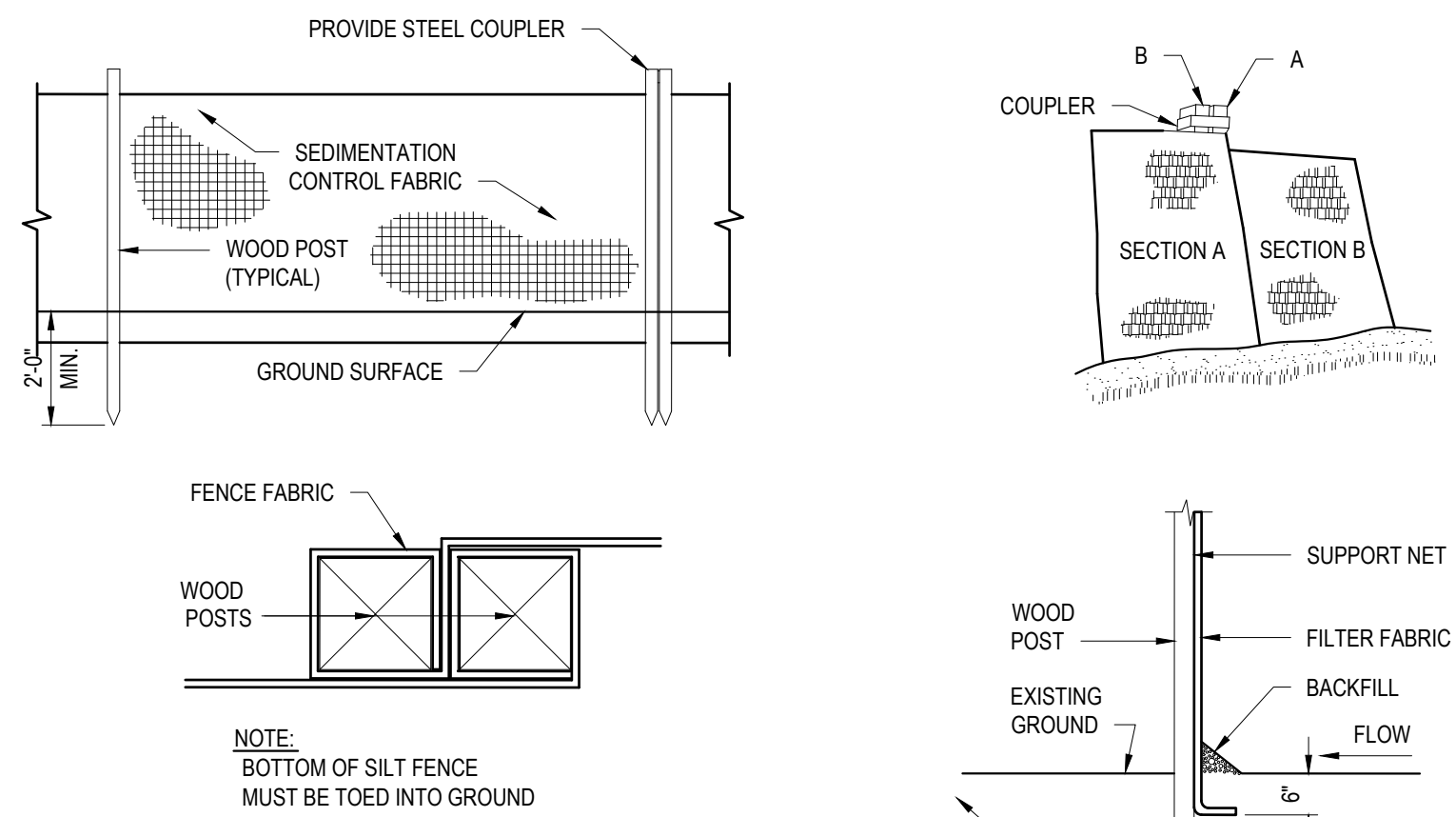

NTS

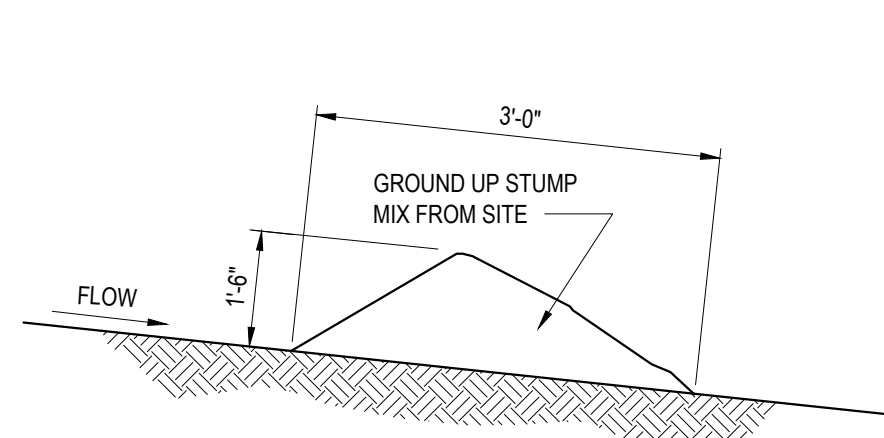

N.T.S.

1. EXCAVATE A 6"X6" TRENCH ALONG THE LINE OF PLACEMENT FOR THE FILTER BARRIER.
2. UNROLL A SECTION AT A TIME AND POSITION THE POSTS AGAINST THE BACK (DOWNSTREAM) WALL OF THE TRENCH.
3. DRIVE POSTS INTO THE GROUND UNTIL APPROXIMATELY 2" OF FABRIC IS LYING ON THE TRENCH BOTTOM. JOIN SECTION AS SHOWN ABOVE.
4. LAY THE TOE-IN FLAP OF FABRIC ONTO THE UNDISTURBED BOTTOM OF THE TRENCH, BACKFILL THE TRENCH AND TAMP THE SOIL. TOE-IN CAN ALSO BE ACCOMPLISHED BY LAYING THE FABRIC FLAP ON UNDISTURBED GROUND AND PILING AND TAMPING FILL AT THE BASE. BUT MUST BE ACCOMPLISHED BY AN INTERCEPTION DITCH.
5. BARRIER SHALL BE MIRAFI SILT FENCE OR APPROVED EQUAL.



2 CUMMINGS PARK DRIVE
WOBURN, MA 01801

PRELIMINARY
NOT FOR CONSTRUCTION

MBG MAINE EXPANSION AND RENOVATION

353 RIVERSIDE DRIVE
AUBURN, MAINE

[illegible]

SHEET TITLE

EROSION CONTROL DETAILS

DESIGNED BY:	ED
DRAWN BY:	BVD
PROJECT NUMBER:	23-079

C300